



Hikari LED Headlight Kit

Installation Instructions (continued)

Beam Pattern adjustment for H13/9004/9007

In some applications, these may require bulb body to be rotated in relation to locking ring to achieve desired pattern. Follow steps below to adjust.

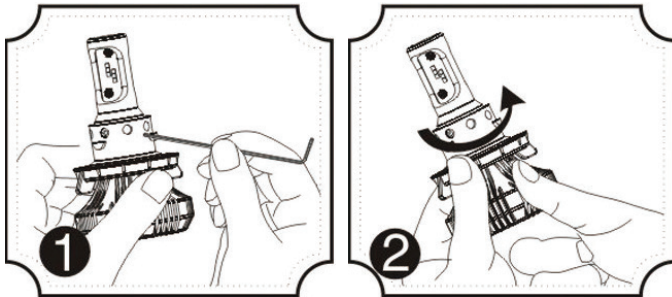

To adjust, remove allen screw on locking ring. Rotate bulb body in ring to desired position. Reinstall allen.

Warranty Agreement

1. A Lifetime Warranty is given from the date of purchase to the original purchaser. The warranty is for free repair or replacement and covers manufacturing faults only. Labor costs are not covered by warranty.
2. Warranty exclusions:
 - Any damages caused from improper operation or connecting voltages other than 9~32 VDC.
 - The product appears to have excessive physical damage.
3. Repair or replacement as provided under this warranty is the exclusive remedy to the customer. We shall not be liable for any incidental or consequential damages for breach of any stipulation in this warranty.

LED Headlight Kit Installation Manual

H4-HLV4	9004-HLV4	PSX24W-HLV4
H7-HLV4	9005-HLV4	PSX26W-HLV4
H8-HLV4	9006-HLV4	
H10-HLV4	9007-HLV4	
H11-HLV4	9012-HLV4	
H13-HLV4		
H16-HLV4		





Safety and Notes

1. Product shall be installed and serviced by a qualified technician.
2. LED headlight replacements are weatherproof when used in an approved headlight housing assembly.
3. Good heat dissipation will prolong the working life of the driver, ensure good ventilation.
4. Check voltage of the vehicle to be sure it complies with working voltage of the product. (9~32 VDC)
5. Ensure all wire connections and polarities are correct before applying power to avoid any damages to the LED lights.
6. If a fault occurs, return product to Super Bright LEDs. Do not attempt to fix this product by yourself.

MAKE SURE HOOD IS POSITIONED AS SHOWN ONCE INSTALLED

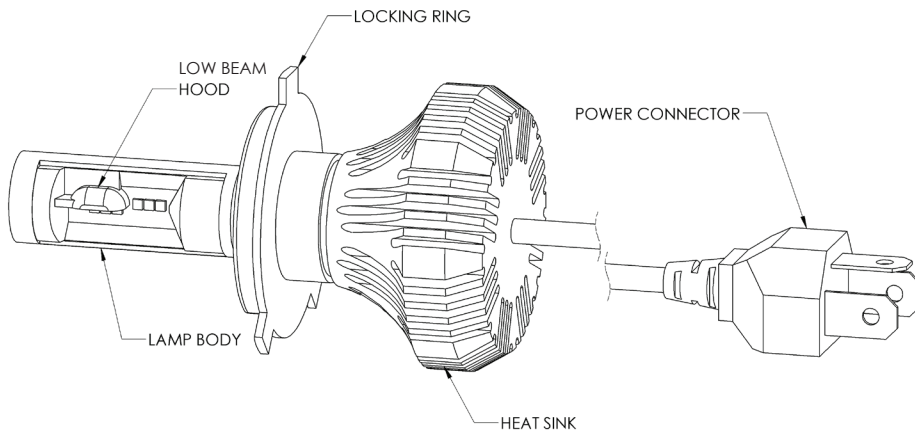

FIG. 1

Website: hikari-led.com

Installation Instructions

Remove bulb retaining ring if so equipped and remove stock bulb.

H4/H7/9007

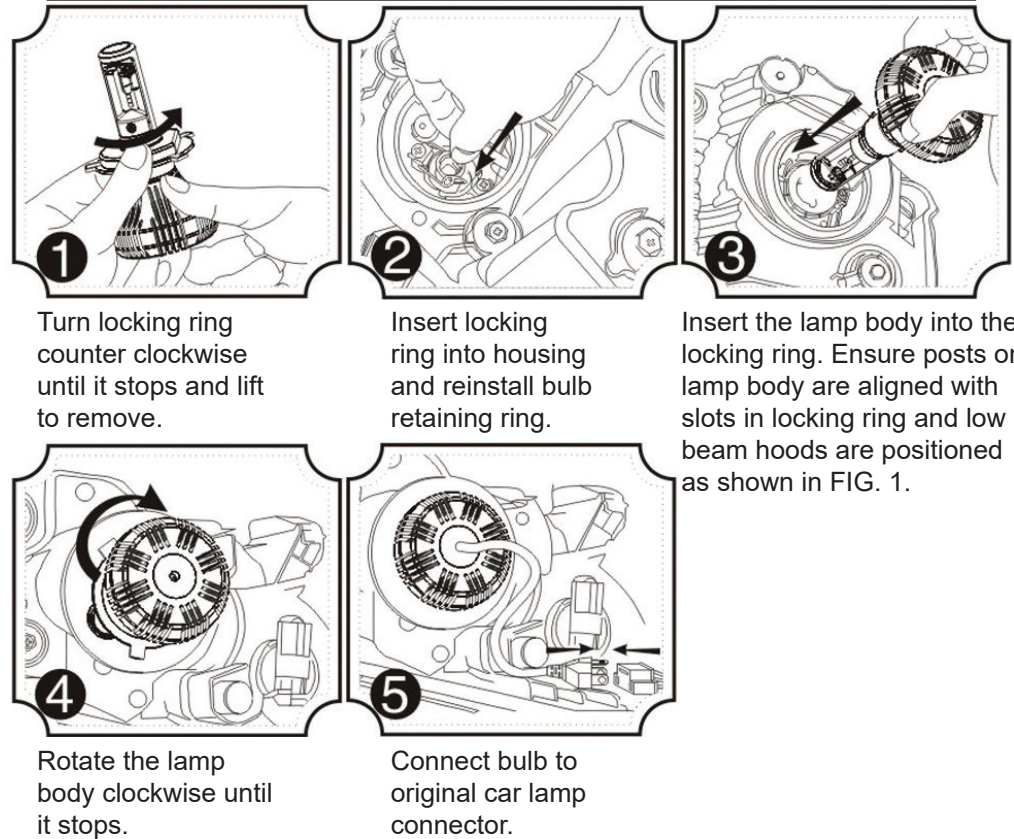

H8/H11/H13/H16JP/P13/9004/9005/9006/PSX24/PSX26

